

# General Assembly of Base Tool 07536-02200

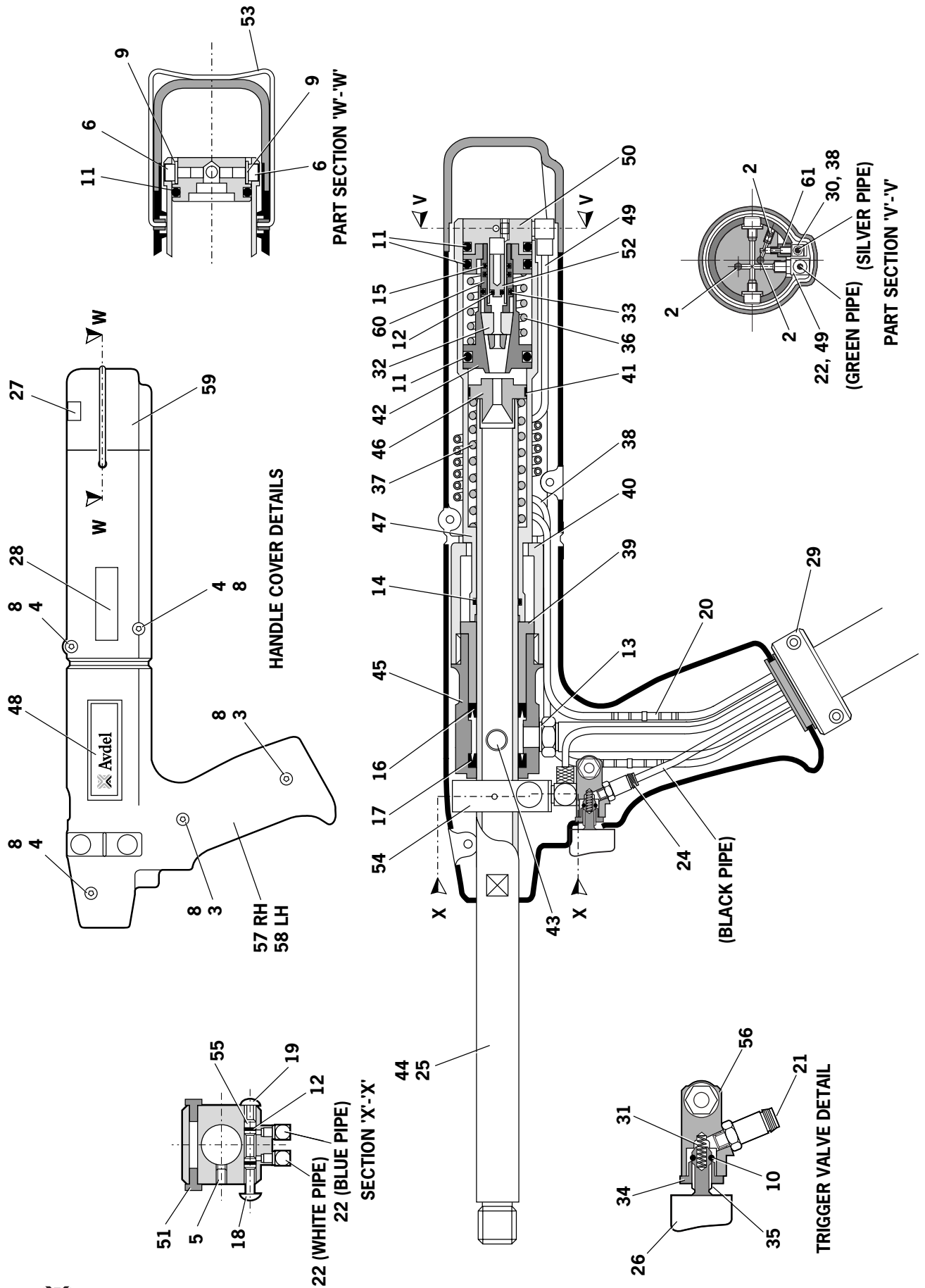

# Parts List for Base Tool 07536-02200

| 07536-02200 PARTS LISTS |             |                                  |        |        |      |              |   |     |        |
|-------------------------|-------------|----------------------------------|--------|--------|------|--------------|---|-----|--------|
| ITEM                    | PART N°     | DESCRIPTION                      | QTY    | SPARES | ITEM | PART N°      | DESCRIPTION                             | QTY | SPARES |
| 1                       | 07007-00392 | CABLE TIE (NOT SHOWN)            | 1      | -      | 36   | 07154-00404  | SPRING                                  | 1   | -      |
| 2                       | 07001-00499 | M3x5 LONG SOCKET SET SCREW       | 3      | -      | 37   | 07490-03002  | BARREL RETURN SPRING                    | 1   | -      |
| 3                       | 07001-00262 | M4x22 LONG SOCKET HEAD CAP SCREW | 1      | -      | 38   | 07536-02211  | 3MM AIR CURSOR CONCERTINA TUBE - SILVER | 1   | -      |
| 4                       | 07001-00401 | M4x10 LONG SOCKET HEAD CAP SCREW | 4      | -      | 39   | 07536-00203  | PISTON                                  | 1   | -      |
| 5                       | 07001-00404 | M5x6 LONG SOCKET HEAD SET SCREW  | 1      | -      | 40   | 07530-00204  | STROKE LIMITER                          | 1   | -      |
| 6                       | 07001-00504 | M4x6 LONG SOCKET HEAD CAP SCREW  | 2      | 2      | 41   | 07530-00206  | RUBBING STRIP                           | 1   | 1      |
| 7                       |             |                                  |        |        | 42   | 07536-00208  | JAW HOUSING                             | 1   | -      |
| 8                       | 07002-00134 | M4 HEX NUT                       | 4      | -      | 43   | 07530-00500  | BLEED PLUG ASSEMBLY [ITEMS 62 TO 65] ●  | 1   | -      |
| 9                       | 07002-00153 | M4 WASHER [PLASTIC]              | 2      | -      | 44   | 07536-02201  | BARREL                                  | 1   | -      |
| 10                      | 07003-00022 | 'O' RING                         | 1      | -      | 45   | 07530-02202  | BODY                                    | 1   | -      |
| 11                      | 07003-00113 | 'O' RING                         | 3      | 3      | 46   | 07530-02205  | BARREL PLUG                             | 1   | -      |
| 12                      | 07003-00121 | 'O' RING                         | 3      | 3      | 47   | 07536-02207  | TAIL JAW CYLINDER                       | 1   | -      |
| 13                      | 07003-00142 | 1/8" BSP BONDED SEAL             | 1      | 1      | 48   | 07530-02210  | LABEL                                   | 2   | -      |
| 14                      | 07003-00167 | 'O' RING                         | 1      | 1      | 49   | 07536-02212  | 4MM AIR CURSOR CONCERTINA TUBE - GREEN  | 1   | -      |
| 15                      | 07003-00386 | 'O' RING                         | 2      | -      | 50   | 07536-02213  | REAR PLUG                               | 1   | -      |
| 16                      | 07003-00236 | SEAL [DYNAMIC]                   | 1      | 1      | 51   | 07530-000310 | BLANKING PLUG                           | 2   | -      |
| 17                      | 07003-00237 | SEAL [STATIC]                    | 1      | -      | 52   | 07536-02214  | STOP                                    | 1   | -      |
| 18                      | 07004-00058 | 1/8" STARLOCK WASHER CHROME      | 1      | -      | 53   | 07530-02220  | CLIP                                    | 1   | -      |
| 19                      | 07004-00059 | 1/8" STARLOCK WASHER BLACK       | 1      | -      | 54   | 07530-02301  | SWITCH BLOCK                            | 1   | -      |
| 20                      | 07005-10073 | 3MM CONNECTOR                    | 1      | -      | 55   | 07530-02302  | AIR TAIL JAW SPOOL                      | 1   | -      |
| 21                      | 07005-01357 | COLLET TYPE CONNECTOR            | 1      | -      | 56   | 07530-02311  | TRIGGER HOUSING                         | 1   | -      |
| 22                      | 07005-01571 | ELBOW CONNECTOR                  | 3      | -      | 57   | 07536-02601  | HANDLE MOULDING ASSEMBLY RIGHT HAND     | 1   | -      |
| 23                      | 07536-02216 | LOCKNUT                          | 1      | -      | 58   | 07536-02602  | HANDLE MOULDING ASSEMBLY LEFT HAND      | 1   | -      |
| 24                      | 07005-10074 | 2MM CONNECTOR                    | 1      | -      | 59   | 07530-02603  | END CAP                                 | 1   | -      |
| 25                      | 07007-00017 | DUST CAP                         | 1      | -      | 60   | 07536-02800  | TAIL JAW PISTON ASSEMBLY                | 1   | -      |
| 26                      | 07007-00300 | TRIGGER BUTTON                   | 1      | -      | 61   | 07536-02215  | FITTING ADAPTER                         | 1   | -      |
| 27                      | 07007-01503 | BOOK SYMBOL LABEL                | 1      | -      | 62   | 07003-00142  | ● BONDED SEAL (NOT SHOWN)               | 1   | 1      |
| 28                      | 07007-01504 | CE MARK LABEL                    | 1      | -      | 63   | 07003-00194  | ● BONDED SEAL (NOT SHOWN)               | 1   | 1      |
| 29                      | 07008-00438 | FLEXIBLE HOSE ASSEMBLY           | 1      | -      | 64   | 07001-00442  | ● SCREW (NOT SHOWN)                     | 1   | 1      |
| 30                      | 07005-01323 | M3 BARB ELBOW                    | 1      | -      | 65   | 07530-00501  | ● PLUG (NOT SHOWN)                      | 1   | -      |
| 31                      | 07125-00215 | SPRING                           | 1      | -      |      |              |   |     |        |
| 32                      | 07151-00403 | TAIL JAWS                        | 1 pair | 2      |      |              |   |     |        |
| 33                      | 07003-00016 | 'O' RING                         | 1      | -      |      |              |   |     |        |
| 34                      | 07220-00803 | RETAINER                         | 1      | -      |      |              |   |     |        |
| 35                      | 07241-00208 | SPINDLE                          | 1      | -      |      |              |   |     |        |